

## LMA 23H Series - Circular Backshells

For use with: MIL-DTL-38999 Series III / EN3645, MIL-DTL-38999 Series IV

### Features

- Dedicated to cable assemblies where additional space is required between the rear of the connector and the strain relief
- Sealing and strain relief of backshell by heat shrink boot
- Overall 360° screening against EMI/RFI interference or reliable fibre-optic strain relief termination
- Tool-free constant force spring or band strap provided



### Additional Component Required

- Heat Shrink Boot
- Calibrated crimping tooling (for **02** termination only)

Part no example: **LMA 23 H 1 - 13 - 05 - 1 - B - 01**

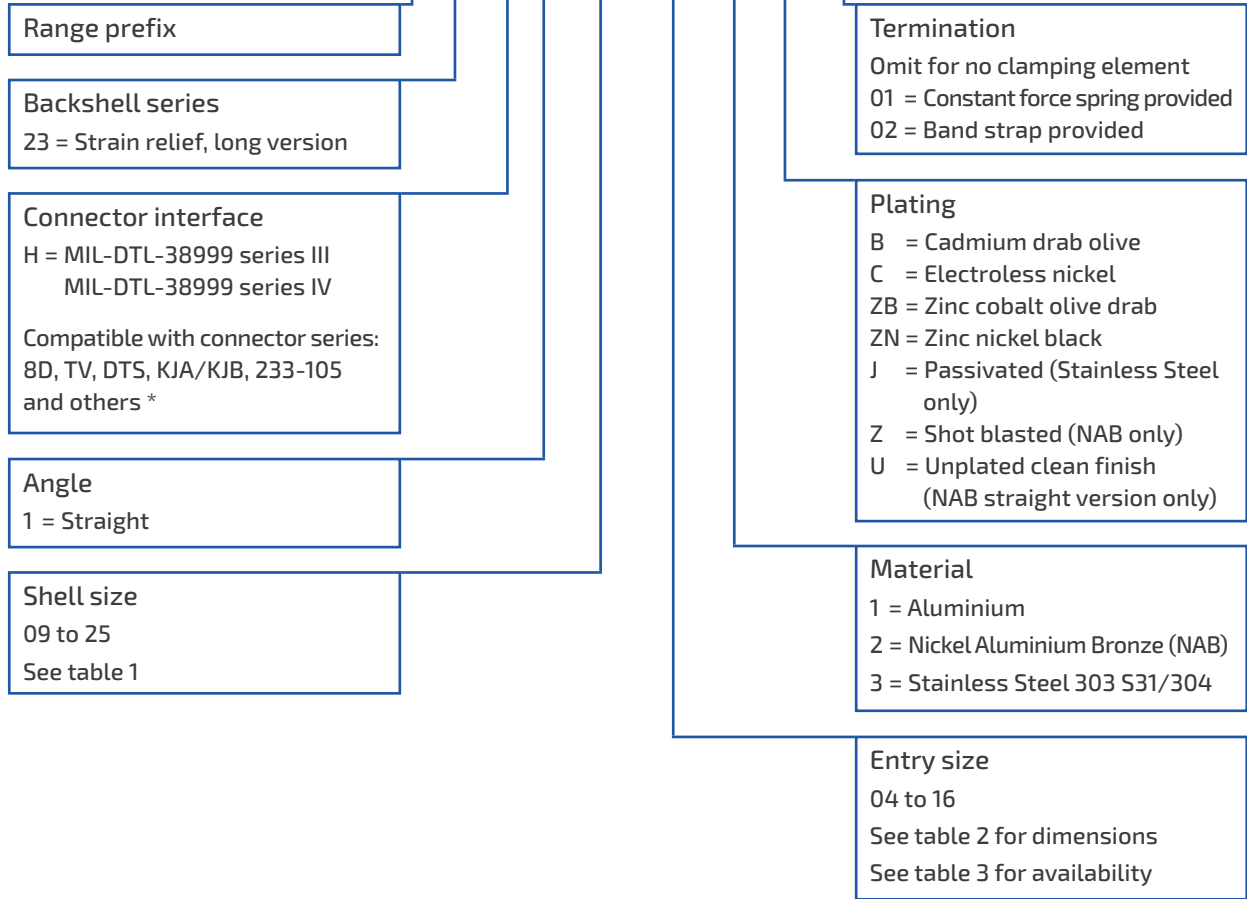

\* - Contact local Sales Office for details

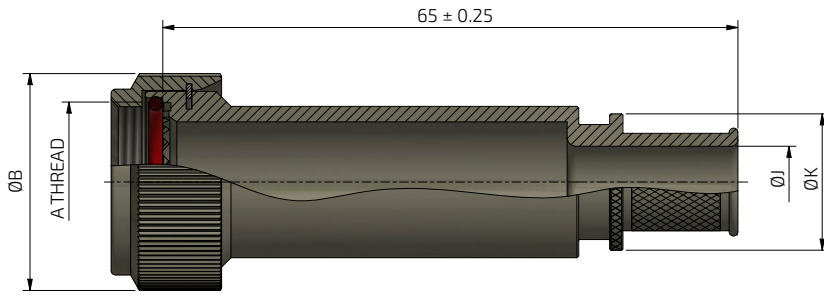

**Constant force spring**

Termination option 01

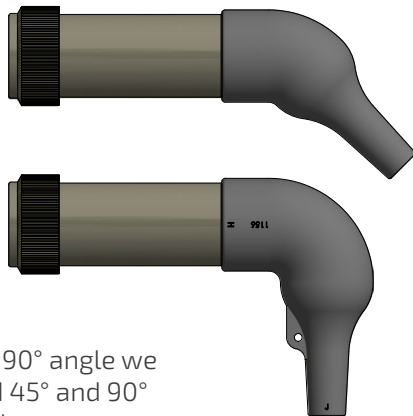
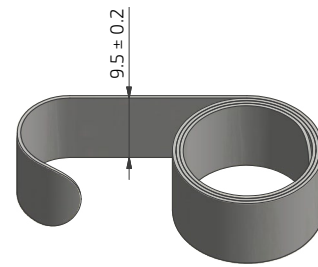

⚠ For 45° and 90° angle we recommend 45° and 90° heat shrink boots. For boot details see page 3.

**Band strap**

Termination option 02

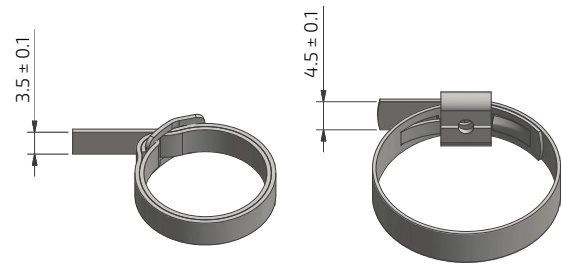

Entry size 04 to 07

Entry size 08 to 16

Table 1

Shell size	A thread	ØB max
09	M12 x 1.0	18.25
11	M15 x 1.0	21.25
13	M18 x 1.0	24.75
15	M22 x 1.0	29.75
17	M25 x 1.0	33.25
19	M28 x 1.0	35.75
21	M31 x 1.0	37.55
23	M34 x 1.0	40.25
25	M37 x 1.0	44.25

Table 2

Entry size	ØJ min	ØK max
04	6.3	13.9
05	7.9	15.5
07	11.1	18.7
08	12.7	20.3
09	14.2	21.9
10	15.8	23.5
11	17.4	25.1
12	19.0	26.7
13	20.6	28.3
15	23.8	31.5
16	25.4	33.1

Table 3

Shell size	Entry size availability (Aluminium only)															
	04	05	07	08	09	10	11	12	13	14	15	16				
09	■															
11		■														
13		■	■													
15		■		■												
17				■		■										
19					■		■									
21						■		■								
23							■		■					■		
25								■		■					■	

⚠ Shell sizes 09 and 11 have one entry size available, whereas shell sizes from 13 to 25 have two entry sizes available. For other entry sizes please contact local Sales Office.

Note: All dimensions are in millimeters (mm)

### Recommended Torque Values (in Nm)

Shell size							
9	11	13	15	19	21	23	25
6	8.5	12	13	13	15	15	15

 Before tightening the spin-coupling adapter, ensure the backshell teeth are correctly aligned and meshed with the connector teeth.

### Recommended Heat Shrinkable Boots

Entry size	Part numbers (HellermannTyton)		
	Straight (150 Series)	45° (1800 Series)	90° (1100 Series)
04	152-42	N/A	1152-4
05	154-42	N/A	1154-4
07	155-42	1803-4	1155-4
08	155-42	1803-4	1155-4
09	155-42	1807-4	1155-4
10	156-42	1807-4	1156-4
11	156-42	1807-4	1156-4
12	156-42	1807-4	1156-4
13	157-42	1806-4	1156-4
14	157-42	1806-4	1157-4
15	157-42	1806-4	1157-4
16	157-42	1806-4	1157-4

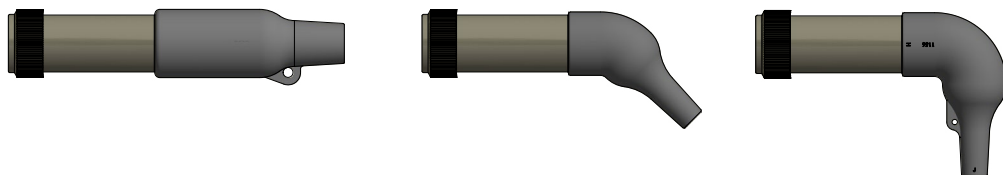

The example part numbers indicated above provide a reference only to dimensional suitability with the associated backshell dimensions. **As many different cable types, materials and dimensions can be used within any given backshell assembly, it is important that the end-user carefully considers all aspects of the final assembly requirements when selecting and specifying appropriate part numbers.** For full part number details, see the Hellermann Tyton catalogue at [fclane.com](http://fclane.com) website. Heat shrink boots and adhesive options are available from FC Lane Electronics Ltd.

## Lodge Group

---

### FC Lane Electronics Ltd

Franchised connector distributor

+44 (0) 1403 790 661  
fclane.com



### Weald Electronics Ltd

Manufacturers of high quality connectors and accessories

+44 (0) 1403 790 715  
wealdelectronics.com



### Lane Motorsport

Division of FC Lane dedicated to motorsport industry

+44 (0) 1403 790 661  
lanemotorsport.com

